

Vanguard

Wall Mounted (WM) Exit DALI

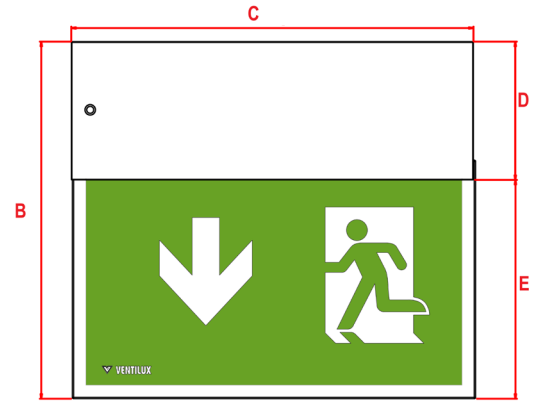
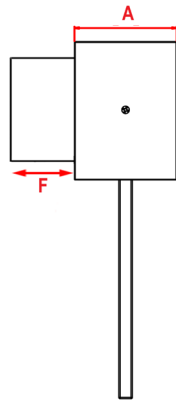

IP 40	8Y Warranty	Stainless Steel	Wall Mounted
32m Viewing Distance	2.5 Kg	NiMh Battery	Class I

Order Code	ZVGD3LEDWMDALI
Mode of Operation	Maintained DALI
Emergency duration	3 hours
Input voltage	230/240V (207Vac - 264Vac) 50/60Hz
Power consumption	7.2VA
Battery charger	Constant Current Nominal charge 0.05A
Battery low voltage cut off	3.0Vdc
Battery discharge current @ 3.6Vdc	0.485A
Battery	Rechargeable 3.6V 2.1Ah NiMh
Lamp	8 x High Powered White Samsung LEDs
Lamp Life	L ₈₀ B ₅₀ 80000 Hours
Nominal lamp current	I _{rated} = 0.35A
Nominal lamp power	P _{rated} = 1W
Cable entry	20mm Rear entry
Luminaire class	Class I
Weight	1.925 kg (no panel) 2.5 kg (c/w Panel fitted)
Packaging Weight	0.2 kg
Standards	BS5266, EN62034, EN61347-2-7, EN61347-2-13, EN 60598-2-22
Environment	0°C to 45°C up to 80% relative humidity.

Materials

Housing: Stainless Steel
Panel Legend: Acrylic

Standard Colour: Stainless Steel
Alternative Colours available upon request

Warranty

Standard Warranty: 8 Years
Alternative Warranty: 10 Years
Add /10Y to order code

System	Order Code	Mode of Operation	Battery	Battery P/N	Viewing Distance	Dimensions (mm)					
						A	B	C	D	E	F
DALI	ZVGD3LEDWMDALI	Maintained	3.6V 2.1Ah NiMh	70272	32 Metres	50	262	298	98	160.5	45
Alternative Systems Available:											
Standalone	VGDM3/LED/WM	Maintained	4.8V 1.3Ah NiMh	70229	32 Metres	50	262	298	98	160.5	45
Central Battery	ZVGDLED240SWM	Slave	n/a	n/a	32 Metres	50	262	298	98	160.5	45

Legends (Ordered Separately)



Left /Right Arrow (Left one side, Right opposite side)
PN: LPVGDISO013VL



Down Arrow (both sides)
PN: LPVGDISO02VL



Up Arrow (both sides)
PN: LPVGDISO04VL

Additional options of Printed Panels available. Contact Ventilux for further details.