

# Atlantic EB Gen 2

## Wall Mounted Exit Sign DALI

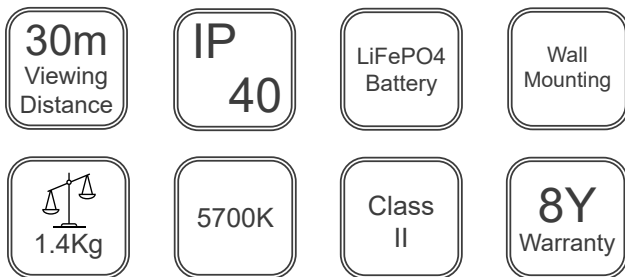
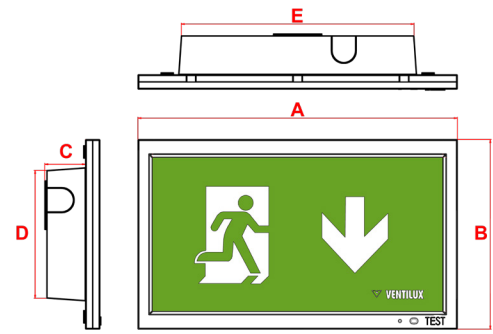
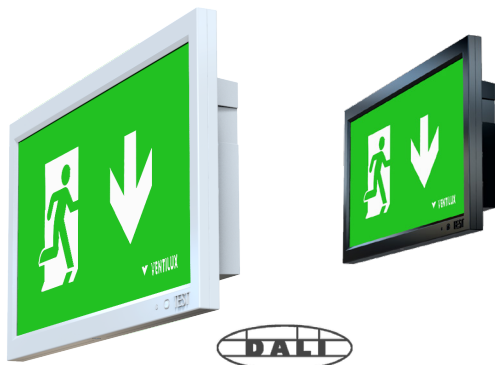

Order Code	<b>ATEB2M3/LED/DA</b>
Mode of operation	Maintained
DALI Interface	For Controlled Monitoring and Reporting
Emergency duration	3 hours
Input voltage	230/240V (207VAC - 264VAC) 50/60Hz
Power consumption	4.5VA, I <sub>nom</sub> = 19mA (Full Battery)
Battery type	Rechargeable LiFePO4 Battery 3.2V 3.2Ah
Battery low voltage cut off	2.5V DC
Battery discharge current @ 3.2V DC	0.43A
Lamp	1W LED Strip
Lamp colour	5700K
Lamp Life	L <sub>80</sub> B <sub>50</sub> 80000 Hours
Viewing Distance	30m
Nominal lamp voltage	V <sub>rated</sub> = 3V DC
Nominal lamp current	I <sub>rated</sub> = 0.35A CC
Nominal lamp power	P <sub>rated</sub> = 1W
Maximum output voltage with no lamp connected	U-OUT = 5V DC
Ingress Protection	IP40
Cable entry	20mm on top, sides and rear of product
Luminaire class	Class II
Product Weight	1.4Kg
Packaging Weight	0.14 Kg
Standards	EN61347-2-7, EN61347-2-13, EN 60598-2-22, EN 55015
Environment	0°C to 45°C up to 80% relative humidity.

## Materials

Housing: ABS  
 Decal Legend: Polypropylene

Standard Colour: White - RAL 9016  
 Alternative Colour: Black - RAL 9017  
 Add /BL to order code

## Warranty

Standard Warranty: 8 Years  
 Alternative Warranty: 10 Years  
 Add /10Y to order code

System	Order Code	Mode of Operation	Battery	Battery P/N	Viewing Distance	Dimensions (mm)				
						A	B	C	D	E
DALI	ATEB2M3/LED/DA	Maintained	LiFePO4 3.2V, 3.2Ah	70261	30	330	195	42	132	240.5
Alternative Systems Available: Specification sheets available upon request										
Standalone	ATEB2M3/LED	Maintained	LiFePO4 6.4V, 0.6Ah	70270	30	330	195	42	132	240.5
DALI Wireless	ATEBM3/LED/DAW	Maintained	LiFePO4 3.2V, 3.2Ah	70261	30	330	195	42	132	240.5
Self-Test	ATEB2M3/LED/ST	Maintained	LiFePO4 3.2V, 3.2Ah	70261	30	330	195	42	132	240.5

## Included Legends



ISO 01



ISO 02

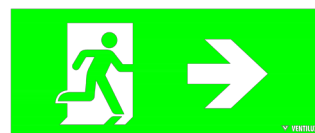

ISO 03

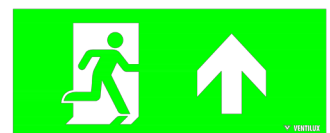

ISO 04